

Product Information

4090



4090

The tables from the 4090 series have a distinct, starkly restrained outline. The optical separation of table top and main frame (achieved through the insertion of spacers) emphasizes the delicacy and airiness of the design. The four tubular steel legs run flush with the edges of the table top, creating a single line of view and a unified composition. Due to their shared design vocabulary, the tables from the 4090 series and the model 4091 folding tables can be freely combined with each other in a wide range of applications.

Frame

4-foot frame without horizontal ribs, wheelchair access on the long side. Frame consisting of two U-shaped side elements made from Ø 35 x 2 mm tubular steel, mitre-welded, welded steel straps, welded 3 cm high transversal plates (edge misalignment), 5 mm thick. Table top fastened with pan head screws.

Frame surfaces

Standard version: chrome-plated, optionally powder-coated according to the BRUNE® collection.

Table tops

Plate C: 30 mm thick, high-quality multi-layer plywood plate E1, top surface optionally covered with HPL plastic or wood veneer according to the BRUNE® collection. Lower surface white HPL or beech veneer. Straight edge, 2 mm thick, in material to match table top (plastic for plastic, veneer for veneer).

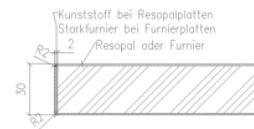

Plate D: 30 mm thick, 28 mm thick high-quality multi-layer plywood plate E1, top surface optionally covered with HPL plastic or wood veneer according to the BRUNE® collection. Lower surface white HPL or beech veneer. Edge with solid beechwood edge band, smooth finish, 9 mm thick.

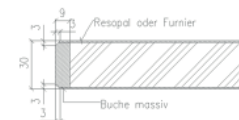
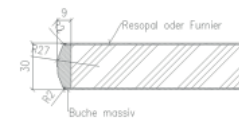

Plate E: 30 mm thick, 28 mm high-quality multi-layer plywood board E1, coated in high-pressure laminate (HPL) or veneer according to the BRUNE® collection. Lower surface: white HPL or beech veneer. Edge: solid beech edge band, crowned, 9 mm thick.



Veneer finish

Real wood veneer from the BRUNE® collection comes as a standard varnished with a low solvent content water-based lacquer, optionally stained to the BRUNE® collection.

HPL surfaces

Resopal®-HPL from the BRUNE® collection.

Gliders

Standard version: Plastic gliders
Optionally: Plastic gliders with height adjustment screws

Dimensions

Table Height: 75 cm (+ 5 mm with height adjustment screws)

Table legs can be shortened on request (for an additional fee).

Dimensions:	70x70	20 kg	trapez	
	120x70	26 kg	140x70x61	23 kg
	140x70	29 kg	160x80x69	28 kg
	160x70	32 kg		
	80x80	23 kg		
	120x80	29 kg		
	140x80	32 kg		
	160x80	35 kg		

Certificates

ISO 9001:2015



Quality management in accordance
with DIN EN ISO 9001

ISO 14001:2015



Environmental management system in
accordance with DIN EN ISO 14001